

ARDEX TLT™ Linear Drain

Foam Pan Installation Guide

STEP 1:

Clean and level substrate (follow all ANSI 108.01 guidelines for substrate prep)

You must begin with a dry and structurally sound subfloor. If water damage, rotting, or any other structural defects are present, you **MUST** repair it prior to installing your new **ARDEX TLT™ Shower Base**. A clean and level subfloor is required for a successful installation. After cleaning the subfloor, use a level to check the subfloor. The subfloor **MUST** be level so that the **ARDEX TLT™ Shower Base** will drain correctly.

NOTE: an ARDEX Flowable Hydraulic Cement Underlayment can be used to level the subfloor: ARDEX LIQUID BACKERBOARD® or ARDEX TL 2000™ over wood / ARDEX TL 1000™ or ARDEX TL 1400™ over concrete.

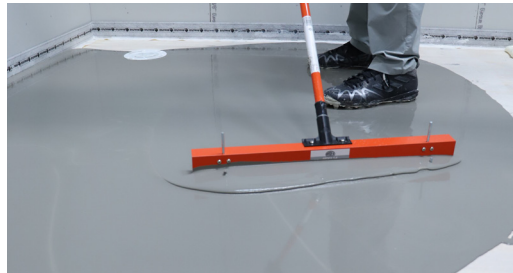

STEP 2:

Cut the drain pipe 7/8" to 1" below subfloor by using an internal PVC pipe cutter drill bit.



STEP 3:

Cut 5" hole centered on drain pipe. The **hub adapter** must sit 1/16" below substrate surface. Ensure the drain pipe is properly secure.



STEP 4:

Follow steps A-C for DRAIN ASSEMBLY

- (A) Insert **threaded drain tube** down through hole in trough.
- (B) Place the down tube with rubber gasket under the trough and screw on to the **threaded drain tube**. Use **red down tube installation tightening tool** to tighten from the top.
- (C) Leave **red tightening tool** in place until ready for tile.

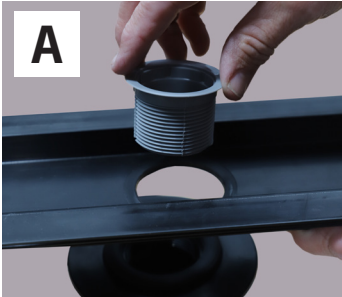

STEP 5:

Dry fit pan and drain fitting to ensure proper fit to framing and walls as well as ensure the drain is centered.



STEP 6:

Mix an ARDEX modified mortar suitable for the subfloor as per manufacturer specification. To assure full coverage, use a 1/4" square notched trowel and apply mortar to the floor and flat trowel the backside of the **ARDEX TLT™ Shower Base**. Assure that the mortar is troweled in the same direction. Set the **ARDEX TLT™ Shower Base** into place (ensuring level perimeter on 4-sided slope pan or level back and drain side on a single slope pan).



STEP 7:

Follow steps A-D for **INSTALLING DRAIN GRATE** on linear drain for mud installation instructions (link below)

<https://ardexamericas2.wpenginepowered.com/wp-content/uploads/2023/08/AF515-ARDEX-TLT-Linear-Drain-mud-bed-installation-guide.pdf>

- (A) Using the **red tightening tool**, loosen and back out (remove) the **threaded down tube**. Place the appropriate **self-adhesive adjustment spacers** into the **trough**. Dry fit the **grate cradle** and adjust **spacers** or combination of **spacers** to set the appropriate height according to the tile thickness.
- (B) Once height and **spacers** are set, screw the **threaded drain tube** through the **grate cradle** and **trough** and tighten down firmly.
- (C) Remove **red tightening tool** and install **strainer**.
- (D) Install **drain grate** using the appropriate **drain grate supporting clips**.



Threaded Down Tube

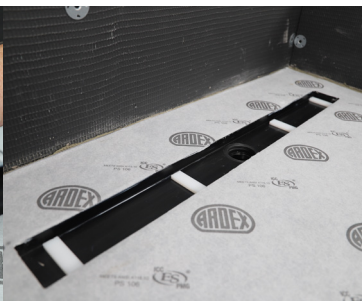

Spacers

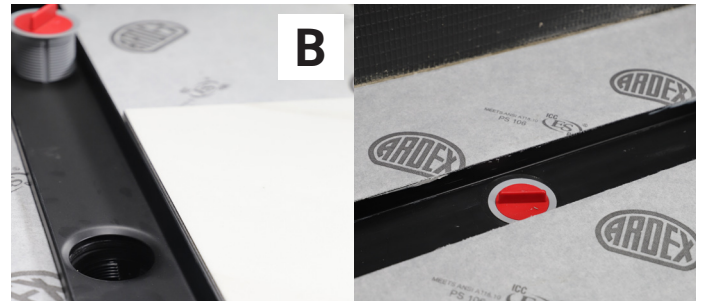

Grate Cradle and Trough

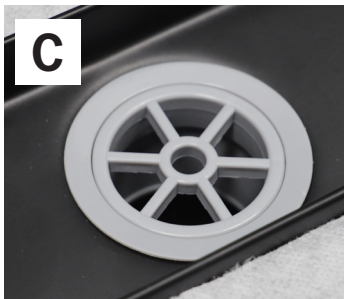

Strainer



Drain Grate Supporting Clips

ARDEX TLT™ Linear Drain Foam Pan Parts List

Part Name	Drain Kit for Foam Pan
Tileable Drain Grate Supporting Clips	X
Square Punch Drain Grate Supporting Clips	X
Self-Adhesive Height Adjustment Spacers	X
Strainer Removal Tool	X
Strainer	X
Threaded Down Tube (Black)	X
Rubber Gasket	X
Down tube Installation Tightening Tool	X
Threaded Drain Tube (Gray)	X
Stainless Steel Grate Cradle	X
Tileable Stainless Steel Linear Drain Grate	X
Square Punch Stainless Steel Linear Drain Grate	X